

Smoke Filter

# RD1101 RD1102 Instruction Manual

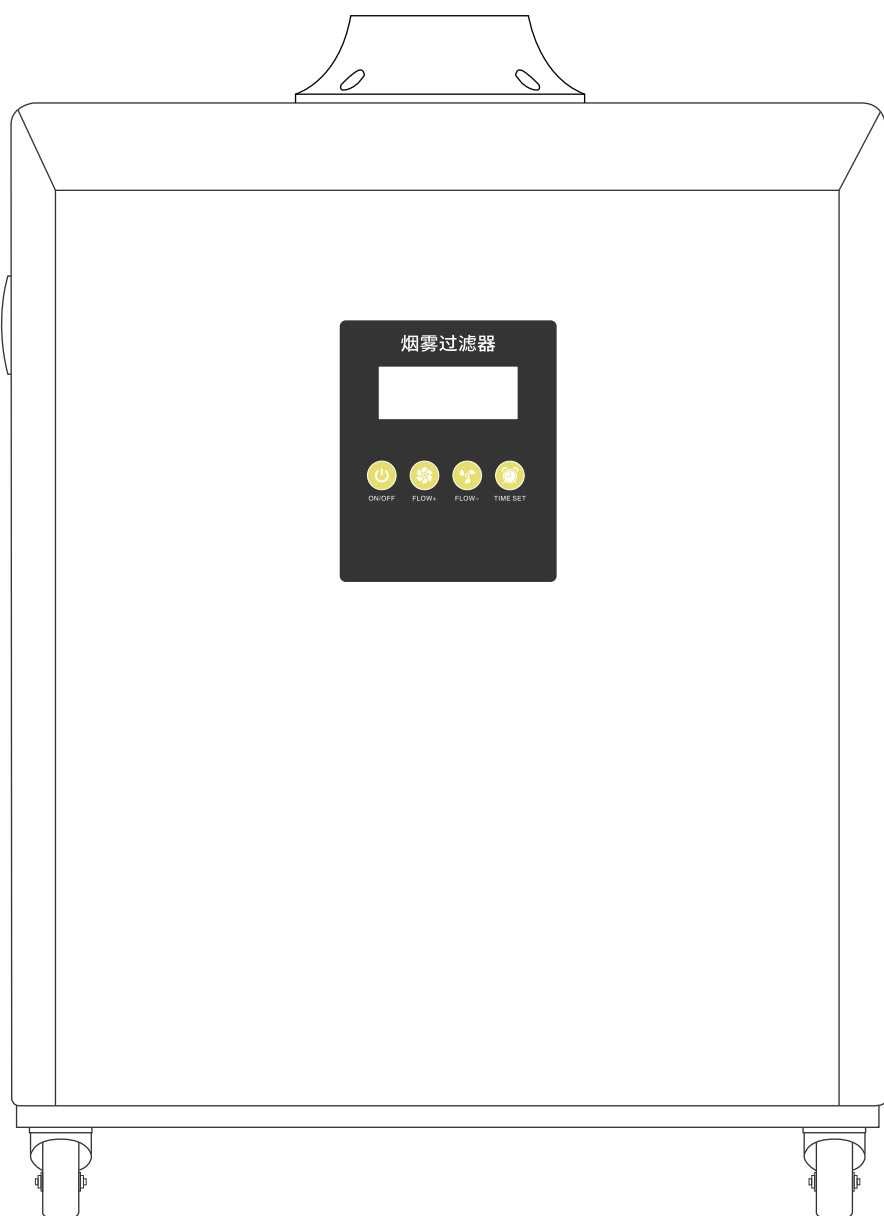

Thank you for purchasing our aerosol suction machine.  
Please read this manual carefully  
before use and keep it properly for future reference

# CONTENT

OVERVIEW

-----

1

PRODUCT FEATURES

-----

2

PACKING LIST

-----

3

FILTERS

-----

4

INSTALLTION INSTRUCTIONS

-----

5

ABOUT DISINFECTION

-----

6

CONTROL PANEL AND REMOTE CONTROL

-----

7

FAQ AND SOLUTIONS

-----

8

STRUCTURE

-----

9

WARRANTY

-----

10

# OVERVIEW

RD1101 and RD1102 is a fume purification system for soldering iron, small engraving, moxibustion and other occasions. Can handle Smoke and dust, peculiar smell, toxic and harmful gas produced in the production process. Has good dust filtration and peculiar smell treatment Function. This product adopts multi-layer filter, which is composed of primary effect filter cotton, medium effect filter, and composite special effect activated carbon filter element. It can effectively filter and absorb a small amount of oil mist and soot particles above 0.3 μ m in the smoke. Soot filtration and purification rate Can reach 99.50%. The special-effect composite special-effect activated carbon filter element can absorb some common toxic and harmful gases, such as benzene and ketones Organic waste gas of type, alcohol, alkanes and their mixed type. Using DC brushless fan, can realize multi-level speed regulation, remote control It has the advantages of high negative pressure and low noise operation. After treatment, the clean air can meet the emission standard and be directly indoors Emission; does not consume indoor air-conditioning, achieving the purpose of purification and energy saving.

# SPECIFICATIONS

Series	RD1101	RD1102
Voltage	220V 50Hz	220V 50Hz
Power	210W	210W
Air volume	320m³/ h	2x160m³/ h
Noise	≤52db(A)	≤52db(A)
Filtration	0.3 μ m 99.5%	0.3 μ m 99.5%
Length of tube	1.4 Meters	1.4 Meters
Size	L400xW255xH485mm	L400xW255xH485mm
Weight	19kg	21kg
Size of flange	75mm/50mm	75mm/50mm

## PRODUCT FEATURES

### CENTRIFUGAL FAN

The fan has a brushless direct current motor with a maximum service life of 40 thousand hours.

We assure the highest reliability, and our fan will require no maintenance. The fan produces low operating noise, high rotation speed, high air volume, high air pressure, and high efficiency

### LCD DISPLAY

Independently developed microcomputer LCD with a programmable single chip bringing digital control. A simple interface displays the operating parameters. The mode of the fan is automatically checked. When there is a blockage in the tubing, or the filter is saturated, and in, other situations, the system will automatically signal an alarm with an audible sound. It will operate with low-pressure power to improve safety.

### REMOTE CONTROL

This product can remotely control basic on-off instructions, accelerate and decelerate suction, timed shutdown functions.

It uses 2.4G wireless technology to achieve 360-degree control within 20 meters. Easy and convenient operations enable flexibility.

### FILTERS

RD1101 and RD1102 is a uses multi-layer filters, made of primary filter cotton,

It is composed of a medium-efficiency filter and a composite special-effect activated carbon filter element. May have

Effectively filter and absorb a small amount of oil mist generated in the smoke, 0.3

Soot particles above  $\mu\text{m}$ . The soot filtration and purification rate can reach 99.50%. The special-effect composite special-effect activated carbon filter element can absorb one

Some common toxic and harmful gases, such as benzene, ketones, alcohols, alkanes

Class and its mixed organic waste gas, etc. Clean after processing

The clean air can meet the emission standards and be directly discharged indoors; no

Consume indoor air-conditioning to achieve the purpose of purification and energy saving.

## PACKING LIST

Description	QTY	Size	Model	Note
Main machine	1 set	L400xW255xH485mm	RD1101/RD1102	
Power cord	1 piece	2 meters 220V 50Hz		Connect with machine
Smoking tube	1 piece	1.4 meters Bamboo tube		
User 's manual	1 book			
Primary effect filter cotton	1 pieces	L360xW220xH30mm	RDSP-101/102-Thick	
Medium efficiency filter	1 piece	L360xW220xH50mm	RDYG-101/102-Moxibustion(50H)	
High efficiency filter	2 piece	L360xW220xH50mm	RDSH-101/102	

Note: The filter element is placed inside the machine

# FILTERS

	Description	Replacement period	Replacing method
1	Primary effect filter cotton	7–15 days	Pull out
2	Medium efficiency filter	2–4 months	Pull out
3	High efficiency filter	6–8 months	Pull out

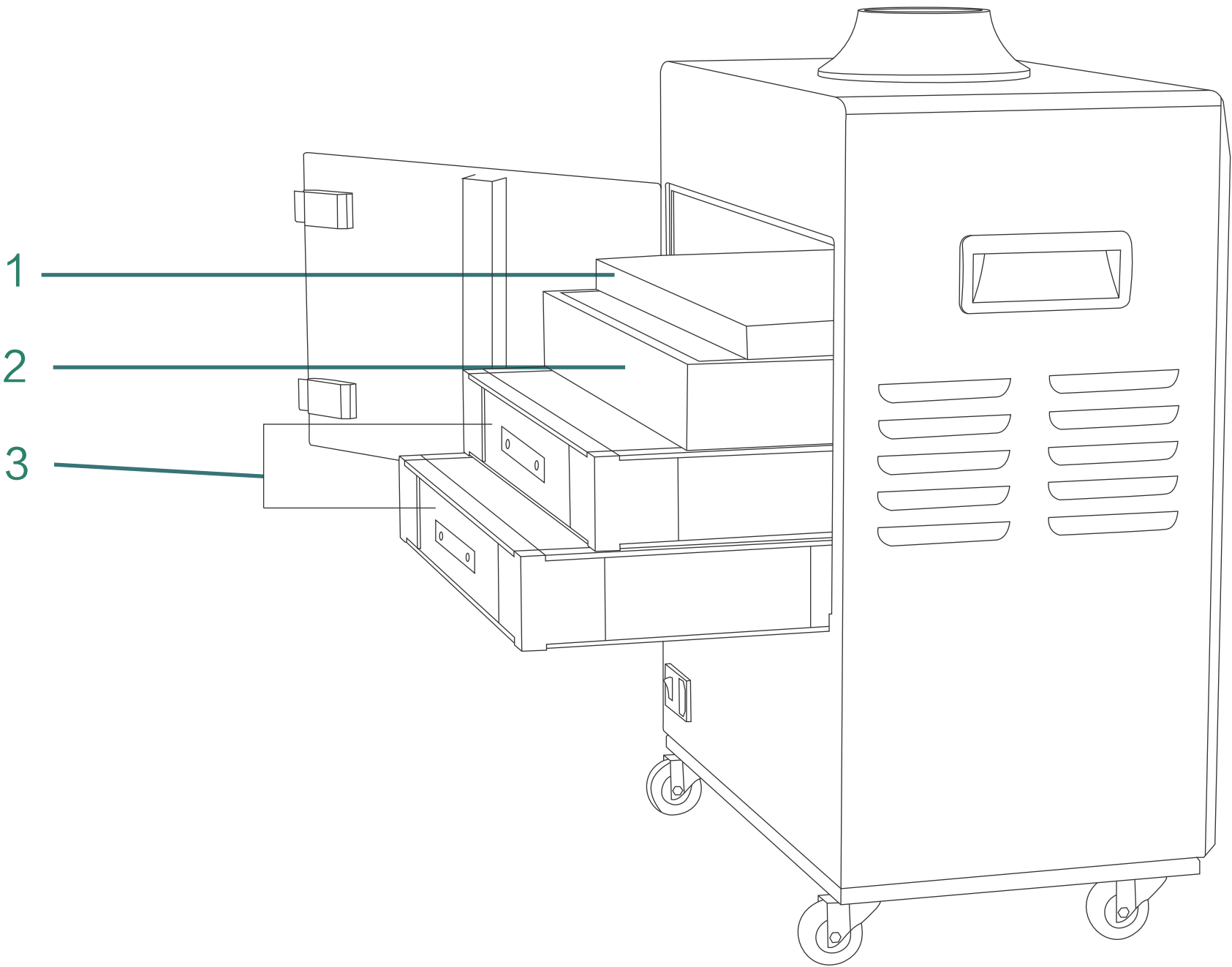

## ABOUT DISINFECTION

### DISINFECTION OF THE FOLDING ARM / SELF-SUPPORTING ARM

I Disinfection of suction nozzle: spray disinfection water, alcohol or other liquid with disinfection function to disinfect the surface.

II Disinfection of the Self-supporting arm: After daily use, please turn on the machine continuously for 30 seconds and then turn it off. At this time, the droplets, liquid, and dust on the support arm can be minimized to the greatest extent.

III When disinfecting regularly, please hold the support arm by hands, hold down the connection between the support arm and the machine, and pull the support arm out of the vertical direction of the device. Afterwards, twist the connection of the support arm clockwise and disassemble it. Separate each section of the support arm, sterilize the inner tube wall, and then assemble it after more than 2 hours.

IV Disinfect the connection between the support arm and the machine: Note that after spraying the disinfection liquid to the connecting part, wipe it as soon as possible and wait for 1 hour.

### DISINFECTION OF THE CASE

I Disinfection of filter element:  
The filter element is recommended to be replaced regularly. It is strictly forbidden to wash and sterilize the filter element other than the primary effect water filter element and then use it again.

II About the disinfection inside the chassis:  
Take out all the filter elements, and then spray disinfection water or other disinfection supplies into the chassis. After spraying, use a soft fabric to clean the inside, and just leave the case for more than 2 hours without closing the case.

III Regarding the disinfection of the disinfection layer:  
The disinfection layer needs to open the bottom cover, usually the disinfection compartment does not need to be disinfected, and a simple disinfection process can be performed when replacing the UV lamp.

**#It is forbidden to use organic solvents to sterilize the equipment.  
During the sterilization process, please bring a mask to prevent dust.**

## INSTALLATION INSTRUCTIONS

1. Insert one end of the power cord to the tern switch and the other end to an electrical outlet.
2. Switch the machine on.

Note: Try to make the nozzle face the mouth while using the machine to improve the suction efficiency.

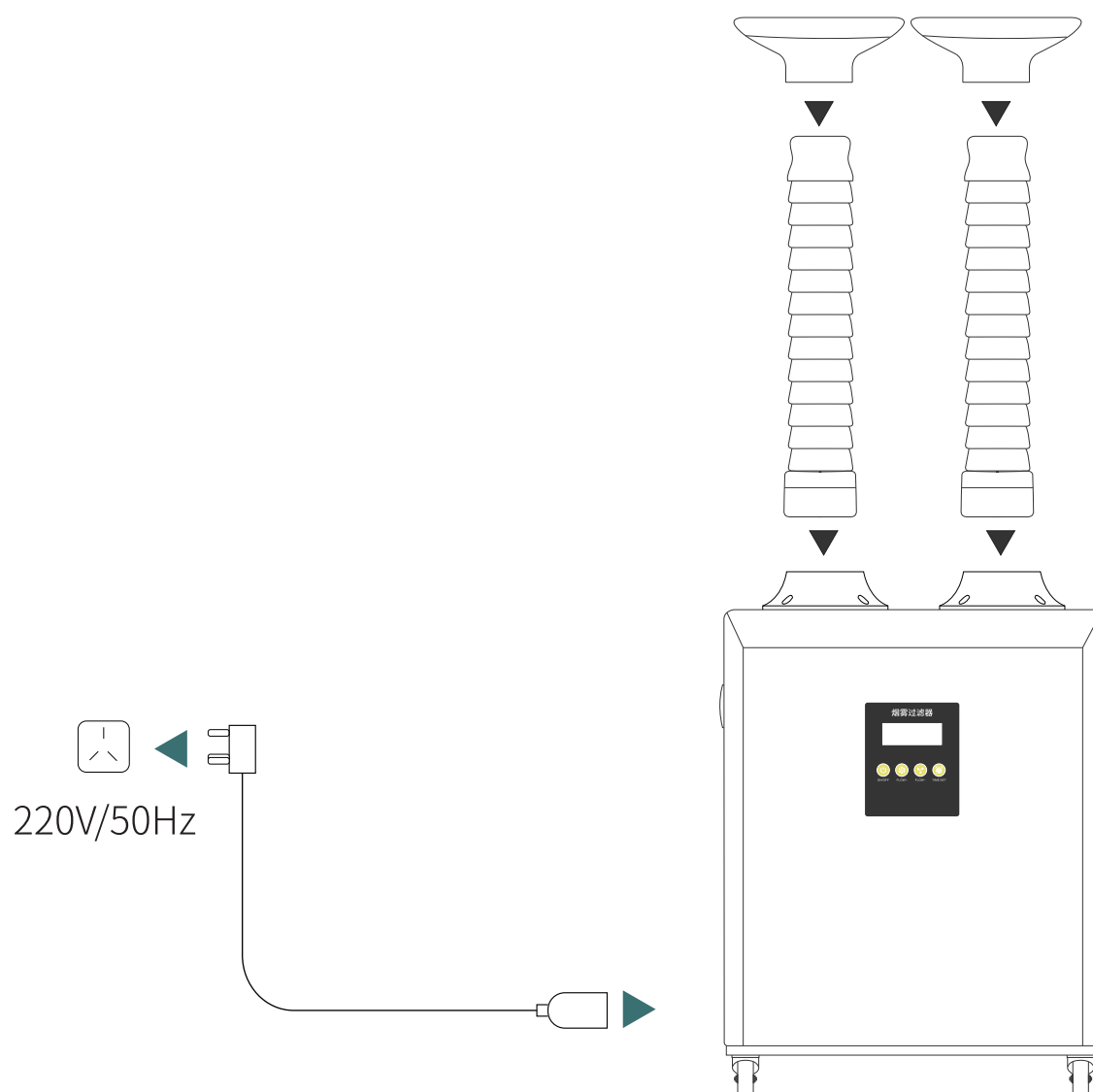

## ELECTRICAL WIRING DIAGRAM

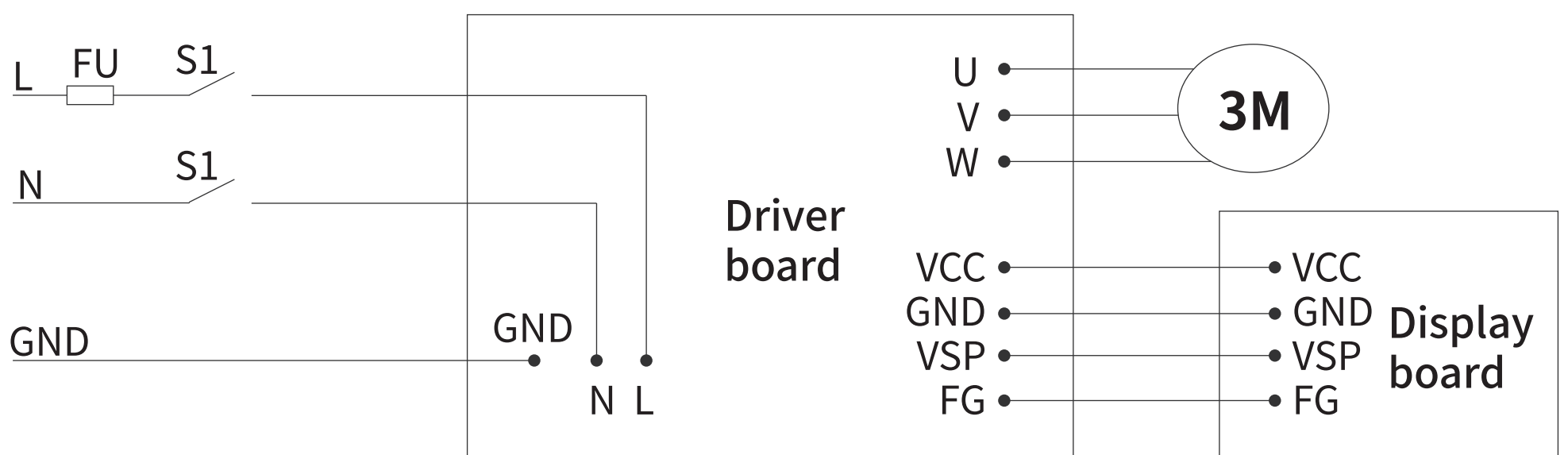



## CONTROL PANEL AND REMOTE CONTROL

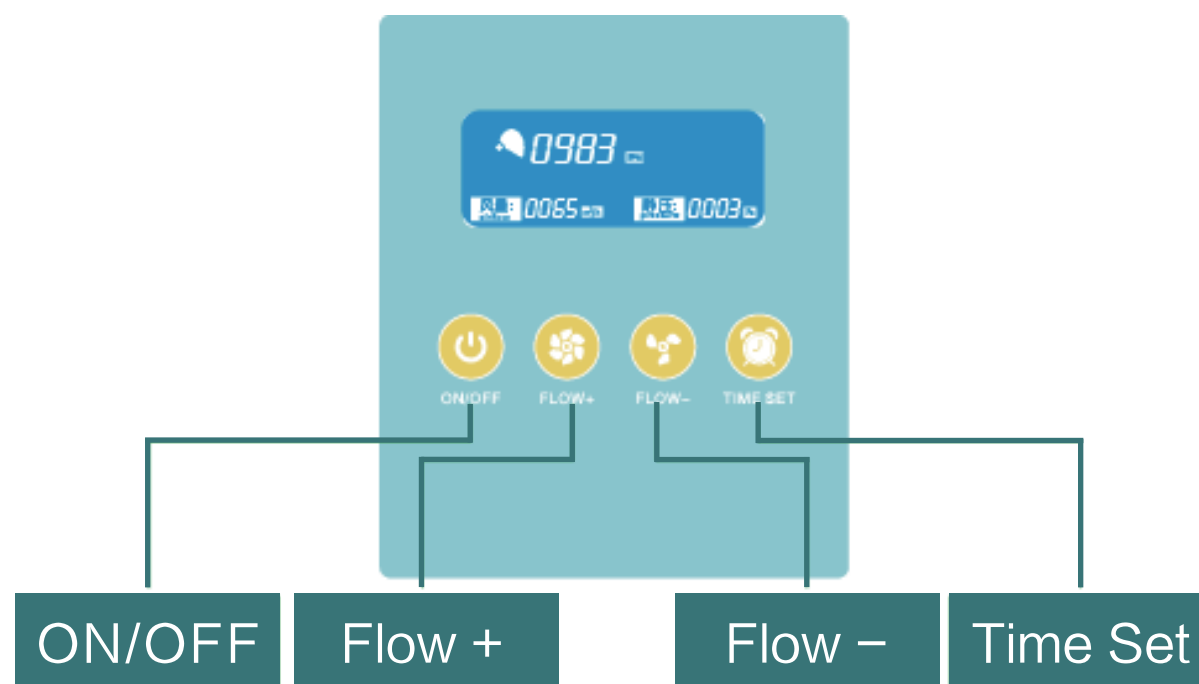

### TIMED SHUTDOWN SETTINGS

When the machine is running, press the key to display the HXXX on the display screen, and then adjust the specific time of the timer shutdown according to the increase and decrease of wind speed. When setting the timer, press the timer key again to adjust the shift of the number of times, tens and hundreds.

After setting, press the OK setting key to confirm the end time of the device. Among them, XXX represents the number of hours the machine operates at a fixed time, with a maximum of 300 hours and a minimum of 1 hour. After setting, press the timer key to query the remaining time on the timer. The display screen displays HXXX. For example, H005 represents the machine will automatically shut down after 5 hours. Set the time to H000 to eliminate the timer.

### REMOTE TIMED SHUT DOWN

When the machine is running, press the key to display HXXX on the display screen, and then adjust the specific time of timing shutdown according to the increase and decrease of wind speed, wherein XXX represents the hours of the timing operation of the machine, with the maximum of 300 hours and the minimum of 1 hour. After setting, press the timer key to query the timing time. The display shows HXXX. For example, H005 represents the machine will automatically shut down after 5 hours. Set the time to H000 can eliminate the timer.

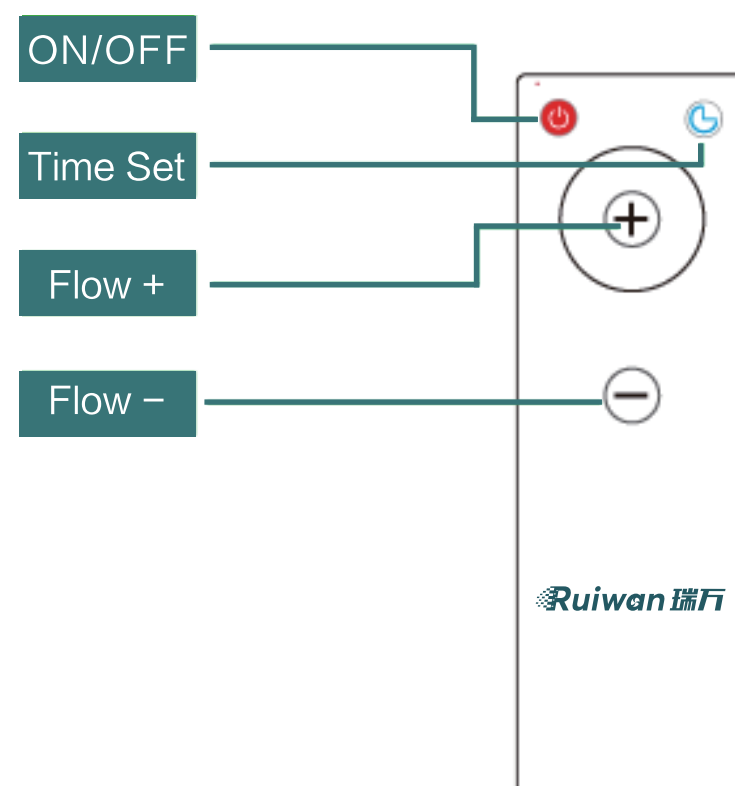



## Fuse replacement

If the device is short-circuited and the fuse is damaged, please follow the steps below to replace the 10A fuse.

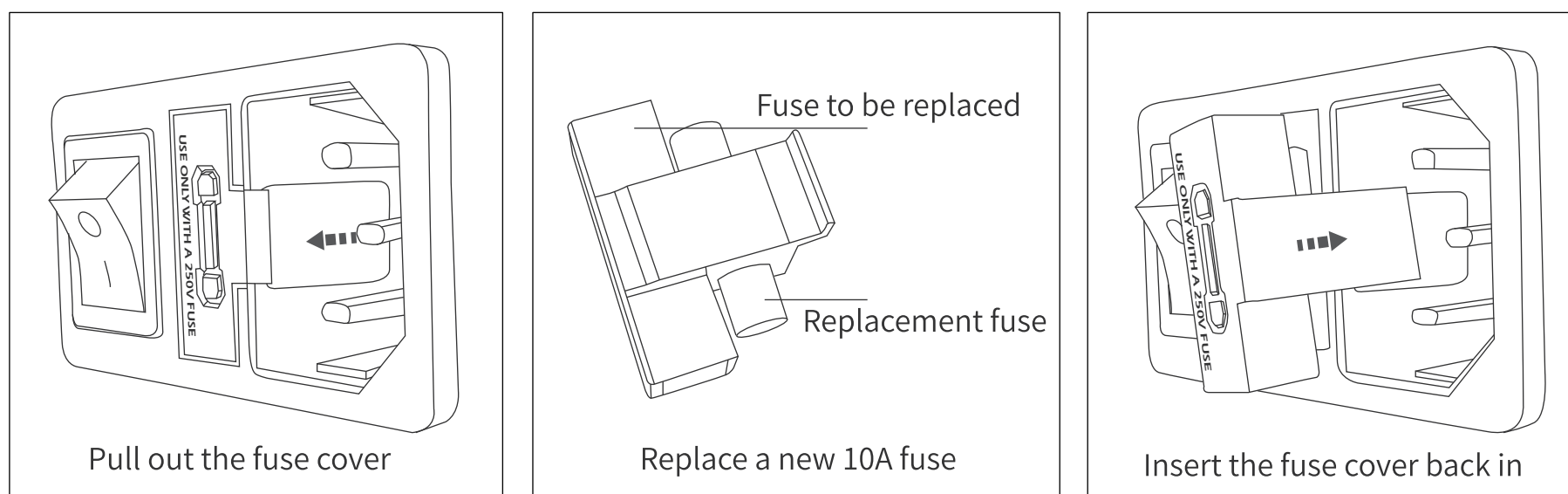

## FAQ AND SOLUTIONS

### 1: The system is still working, but the air volume is weak, and the suction force is significantly reduced.

**Cause:** The air intake is blocked, or there is foreign matter in the tubing, and the filter element reaches saturation failure, resulting in a blocking alarm.

**Check:** turn off the power supply, check whether there is any foreign matter blocking the air intake, and then check whether the air outtake is blocked. If the suction of the air compressor is normal, the filter element needs to be replaced.

### 2: After the machine starts, it will shut down automatically, repeat the above phenomenon appear when turning on again.

**Cause:** The internal airflow is blocked, and the filter element resistance is too large, which leads to excessive starting current of the fan, and the machine will automatically protect and shut down.

**Check:** turn off the power supply and check whether there is any foreign matter blocking the air intake; if there is no abnormality, adjust the air volume to the minimum, restart the machine and adjust the air volume to the appropriate position.

### 3: Turn on the power switch and the indicator light is not on

Check If the connection is good, check if the fuse in the power box is burnt. If it is damaged, replace the fuse.

**Be sure to cut off the power before checking and repairing the equipment !**

# STRUCTURE

1	Air inlet
2	Control panel
3	Handle
4	Air outlet
5	Filter cartridge lock
6	Three in one switch

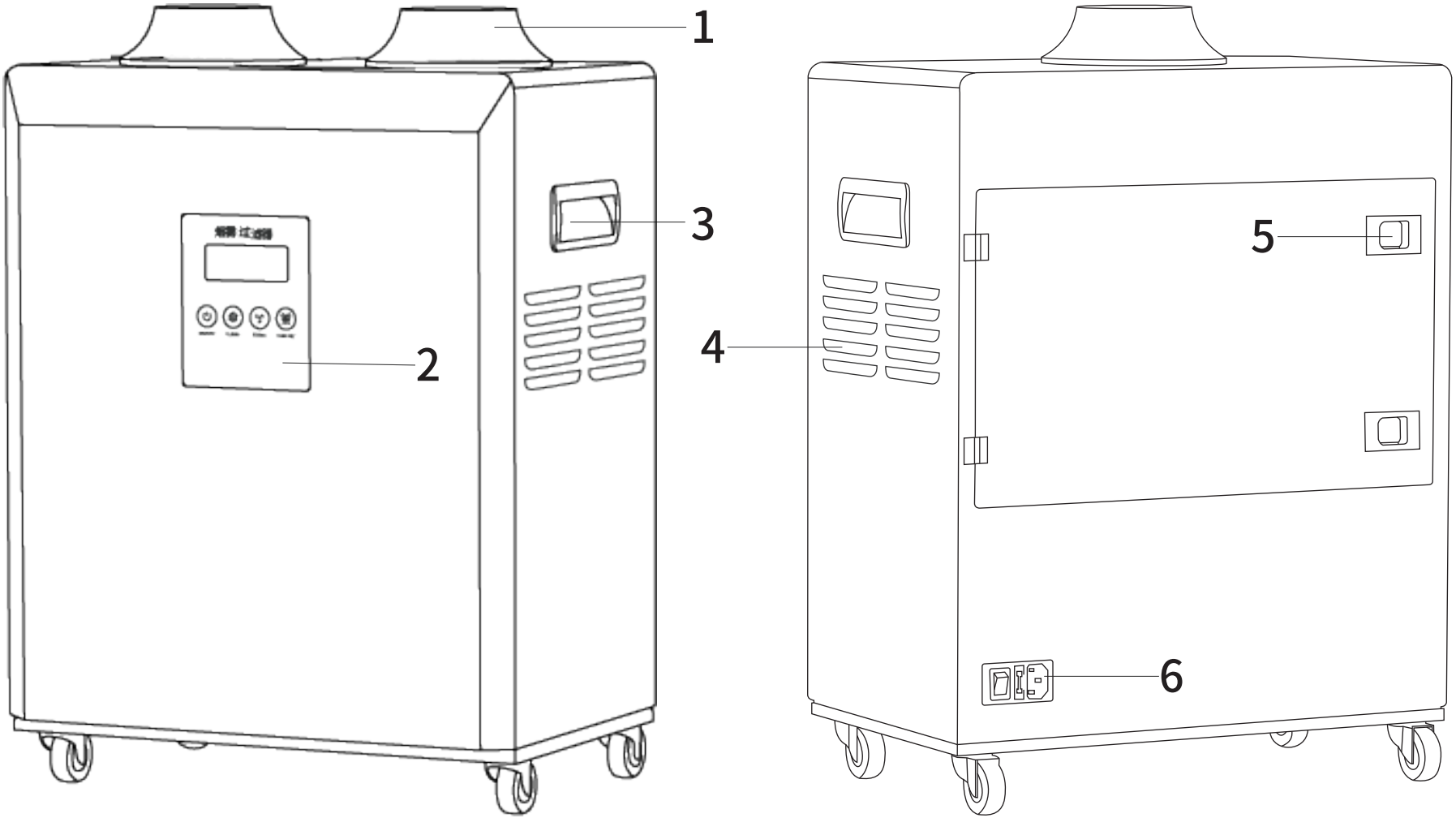

## WARRANTY

As for the warranty (free repair) of goods within the warranty period, it shall be implemented from the date of purchase.

**1.** During the warranty period, the goods can only be repaired in Ruiwan headquarters or dealers recognized by Ruiwan. Please show us this User' s manual(Warranty) and purchase invoice.

**2.** From the date of purchase, the main unit is guaranteed for \_\_3\_\_years. (Note: the filter element belongs to consumables and is not under warranty Scope of repair)

**3.** Under one of the following circumstances, even within the warranty period, it can not be treated as a warranty, but it can be bank charge processing:

- I Damage caused by use, maintenance and storage not under the operating instructions;
- II Damage caused by incorrect operation, abnormal power supply, and falling;
- III Damage caused by dismantling the machine without the consent of the manufacturer;
- IV Failure to prove that the machine is within the valid warranty period;
- V The information on the warranty certificate is inconsistent with or altered from the physical identification of the goods;
- VI Damage due to nuclear and chemical corrosion;
- VII Damage due to natural measures (lightning, earthquake, flood, fire, and other natural disasters).

**4.** Ruiwan company reserves the right of final interpretation of after-sales service terms.

V1.0 2020.04

