

Dust collector

RW301

Instruction Manual

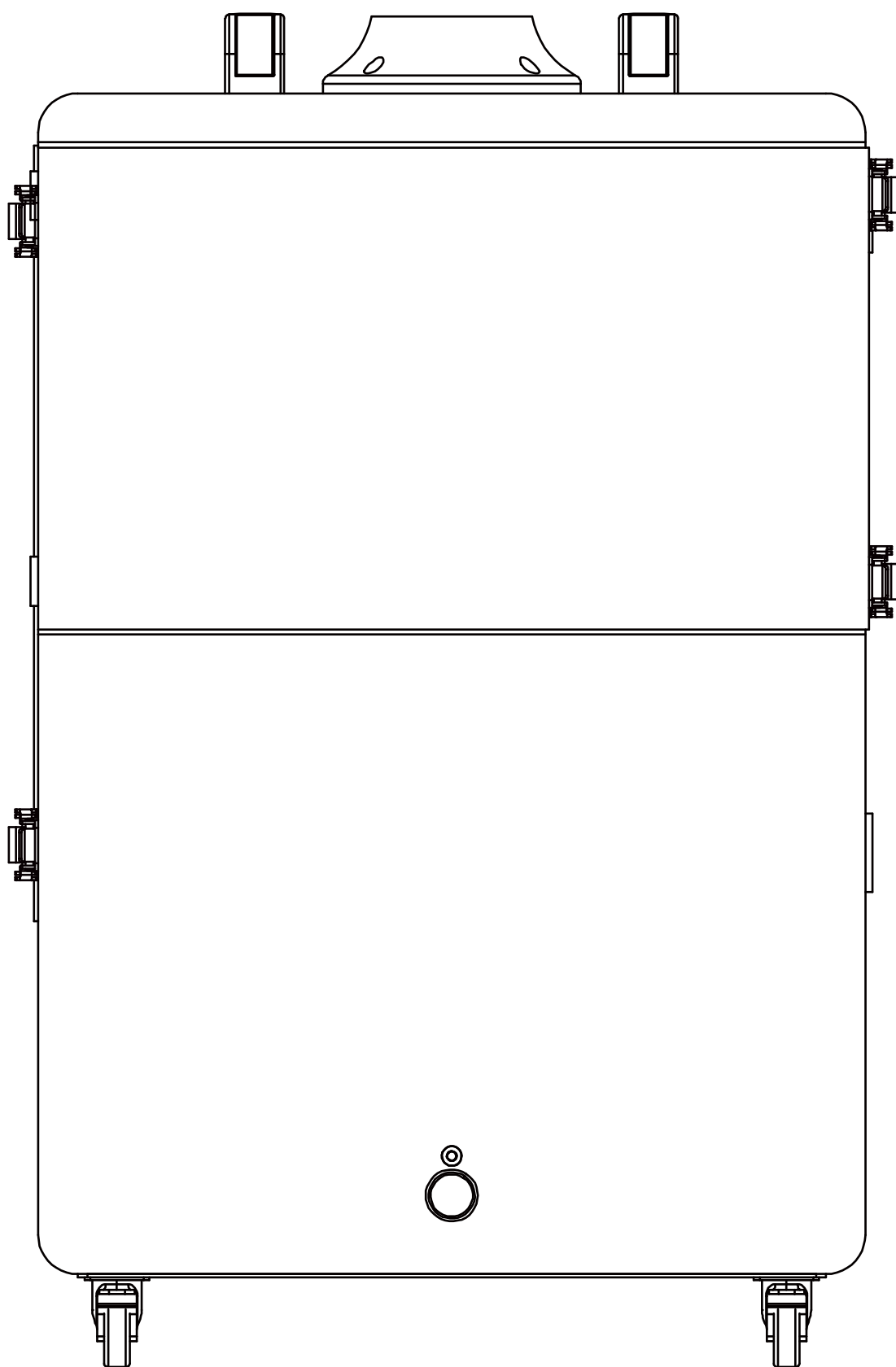

Thank you for purchasing our dust collector.
Please read this manual carefully
before use and keep it properly for future reference.

CONTENT

OVERVIEW	1
SPECIFICATIONS	1
PRODUCT FEATURES	2
PACKING LIST	2
STRUCTURE	3
INSTALLTION INSTRUCTIONS	4
ELECTRICAL CONFIGURATION DIAGRAM	4
FILTERS	5
CONTROL KNOB	6
FUSE REPLACEMENT	6
FAQ AND SOLUTIONS	7
WARRANTY	8

OVERVIEW

This product is a dust filtration and recovery equipment for industrial, medical and beauty, jewellery industry, such as sanding, engraving and other scenes, in line with the "simple and efficient, save money and worry" concept, this product is designed with double doors, it is very convenient for users to Replacement and cleaning of the filter cartridge.

This equipment is paired with a high-precision soot filtration system, which can effectively intercept 0.3µm soot, with a filtration efficiency of up to 99.7%.the smoke and dust can be discharged after filtering, which can make the air continuously fresh and clean, improve the cleanliness of the room, reduce the PM2.5 harm, to create a good working environment.

SPECIFICATIONS

Series	RW301
Voltage	AC110/220V 50Hz
Power	350W
Air volume	550m ³ / h
Filtration	0.3µm 99.7%
Size	L420xW350xH690mm
Weight	30kg
Size of flange	φ75mm
Dust box capacity	3.5L

PRODUCT FEATURES

CENTRIFUGAL FAN

The fan has a brushless direct current motor with a maximum service life of 40 thousand hours.
We assure the highest reliability, and our fan will require no maintenance.
The fan produces low operating noise, high.
rotation speed, high air volume, high air pressure, and high efficiency

FILTERS

This product is equipped with a high-precision film-coated filter drum, which can be cleaned and reused. It can be cleaned and reused, and then filtered through the intermediate effect filter for removing smoke. 0.3μm particles, high filtration efficiency, long service time, low cost of use, excellent for dry soot filtration.
It has high filtration efficiency, long service time, low cost, and excellent filtration effect for dry soot.

PACKING LIST

Description	QTY	Size	Model	Note
Main machine	1 set	L420xW350xH690mm	RW301	
Power cord	1 pcs	1.8 meters		
Smoking pipe	1 pcs	Bamboo tube		
Smoke extraction hood	1 pcs	Silicone rectangular cover		
Filter barrel	1 pcs	Φ200x200mm		
Medium / High efficiency filter	1 pcs	L375xW275xH50mm		either-or
Dust box	1 pcs	3.5L		

Note: The filter barrel is placed inside the machine

STRUCTURE

1	Air Inlet
2	Carrying handle
3	Filter compartment lock
4	Running lights
5	Speed knob
6	Air outlet
7	Three-in-one switch

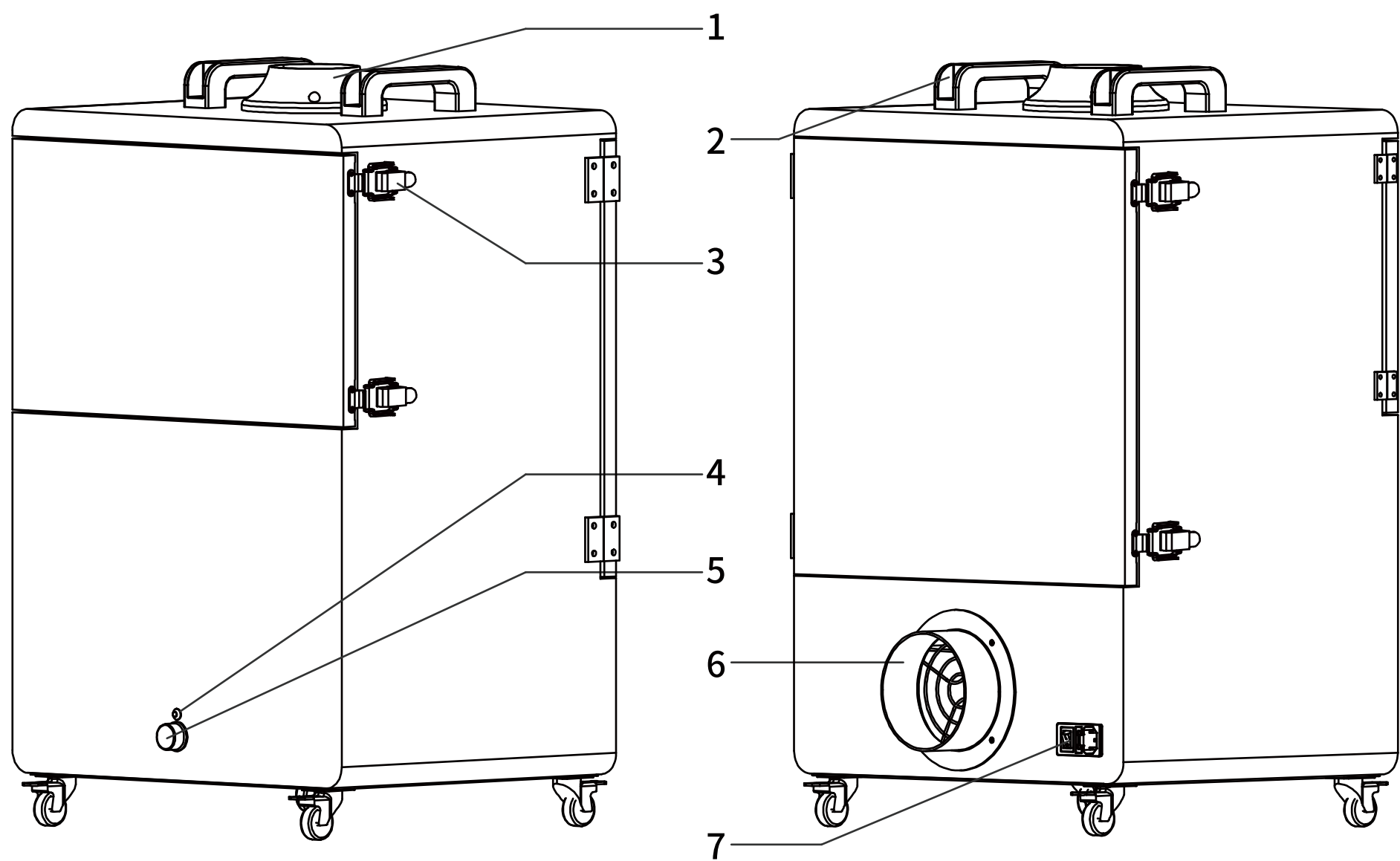

Note:equipment standard does not include air outlet flange port, please prevail in kind.

INSTALLATION NOTES

1. Plug one end of the power cord into the 3-in-1 switch on the unit. Plug the other end into an electrical socket and turn on the switch.
2. Turn the airflow control potentiometer to start working.

Note: When using it, you should try to make the smoking mouth directly to the point of smoke generation. In order to improve the efficiency of smoking and dust collection. The equipment must be switched on with a well grounded plug and socket.

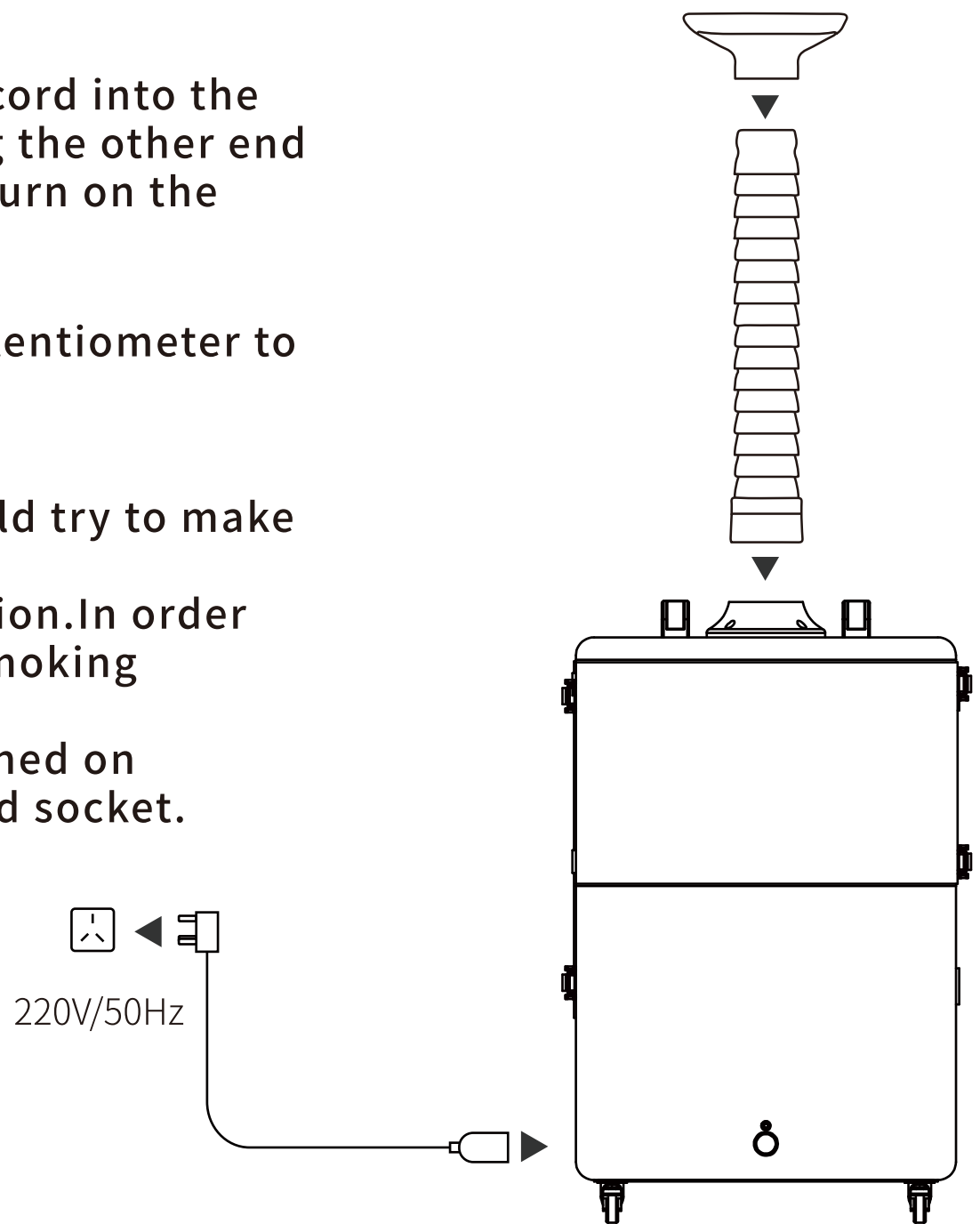

ELECTRICAL CONFIGURATION DIAGRAM

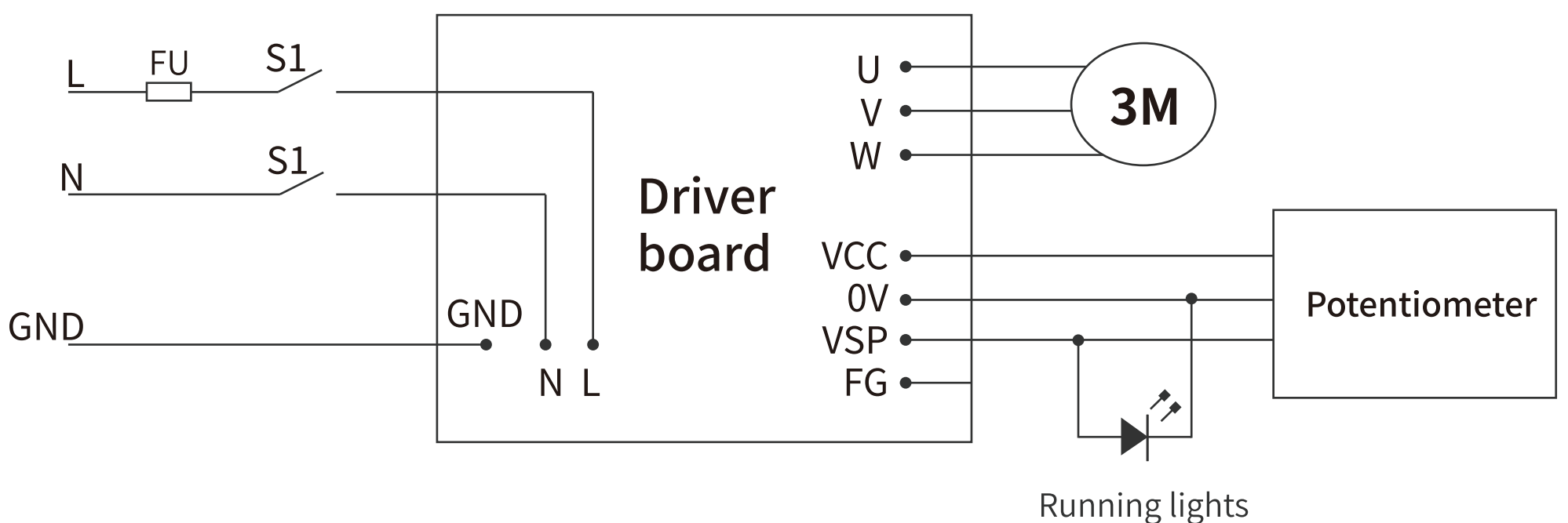

FILTERS

	Description	Replacement period	Replacing method
1	Filter barrel	6-8 months	Turn counterclockwise
2	Dust box	reuse	Pull out
3	Medium efficiency filter	2-4 months	Pull out

Dust removal steps:① Open the frontal hatch;② Wash the drum using an air gun;③ The dust on the filter drum is blown down to the dust collection box, open the back hatch and remove the dust collection box to empty it.

Note:The above replacement cycle is for reference only, the actual replacement time depends on the working conditions.

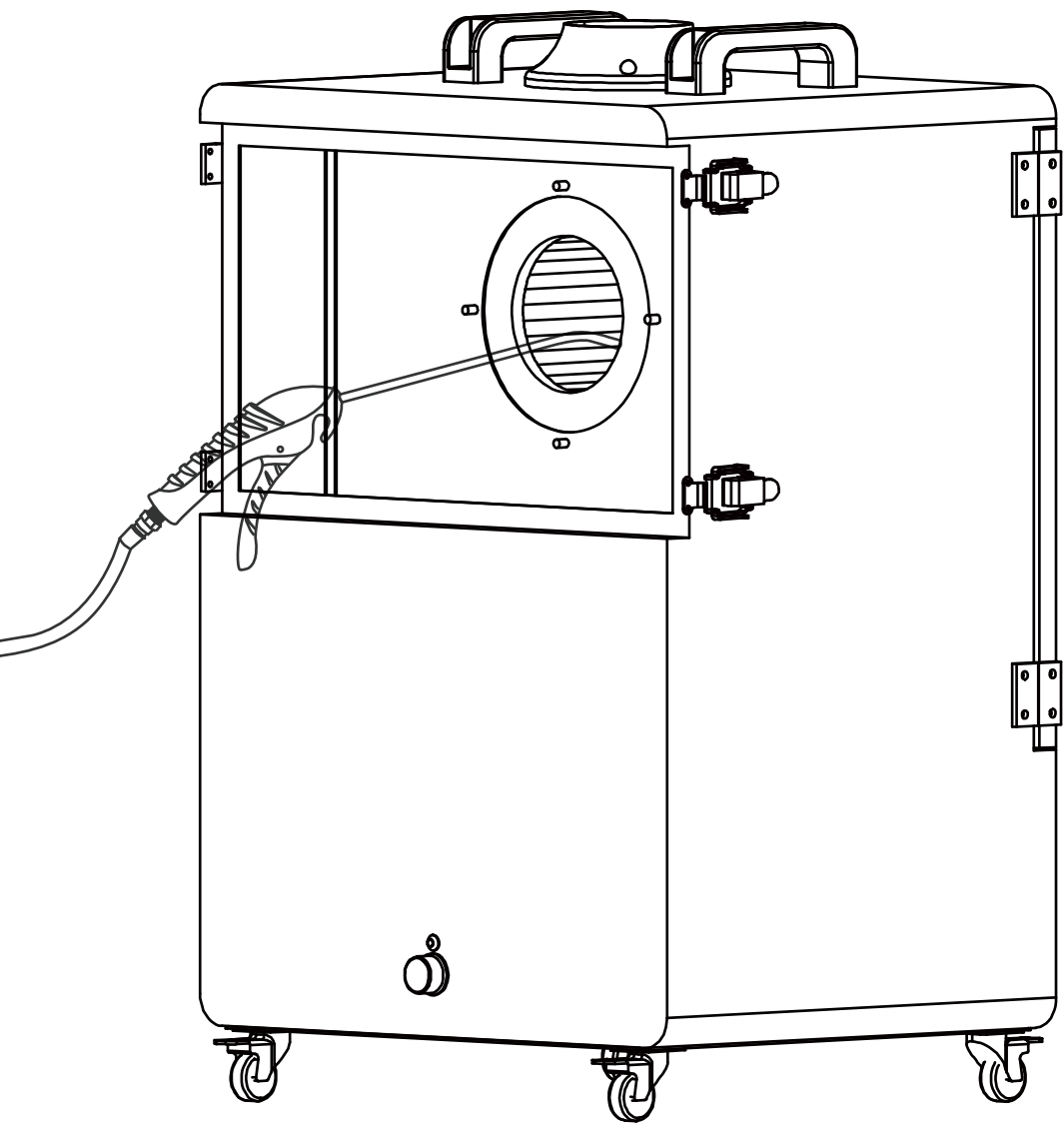

Open the frontal hatch to blow out the dust

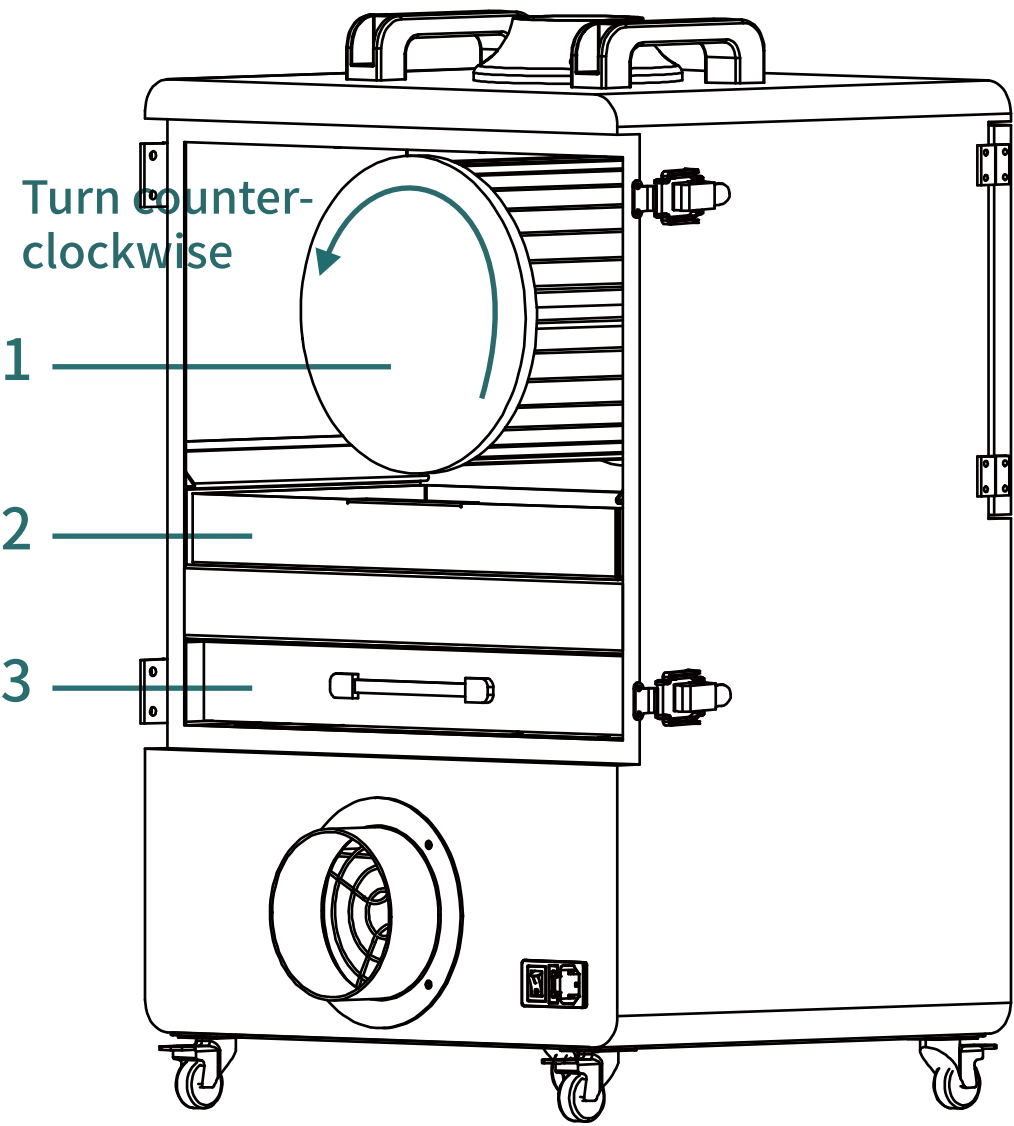

Open the back hatch to empty the ash or replace the filter cartridge

CONTROL ROTATION BUTTON

Plug the power cord into the 3-in-1 power switch and turn on the main switch. switch and turn on the main switch, the device will enter the standby The device will enter standby mode.

Twist the potentiometer clockwise, when it starts to energise, the indicator light is on, the motor then starts to work. The knob travelling is about 270° angle, 0° is the power-off shutdown, the 270° is the maximum speed of the motor. The user can adjust the equipment in real time according to the current The user can adjust the motor speed in real time according to the current working conditions.

Note: Due to the need to meet the purification and filtration needs of different industries, the maximum air volume of this equipment may be oversaturated for the current working conditions. When users use it, they only need to adjust the motor speed to the suction force that can meet the purification and filtration. This operation can also avoid the equipment Excessive noise is produced.

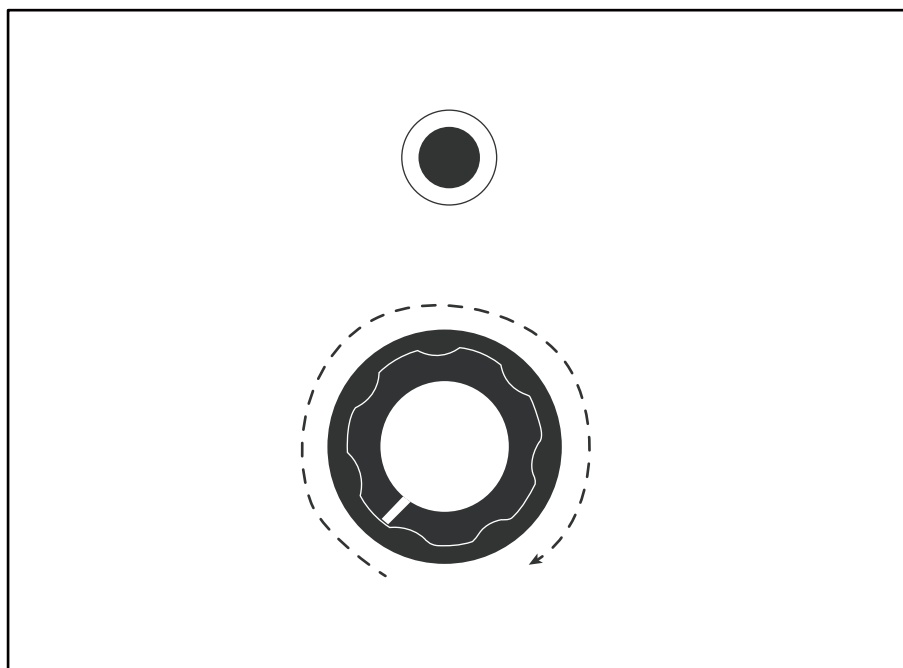

FUSE REPLACEMENT

If the device is short-circuited and the fuse is damaged, Follow the steps below to replace the fuse.

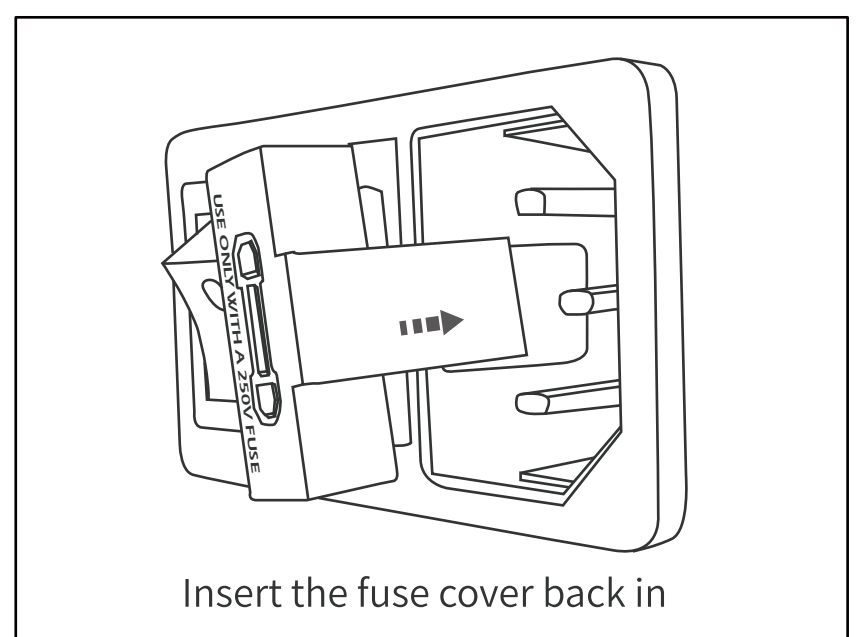
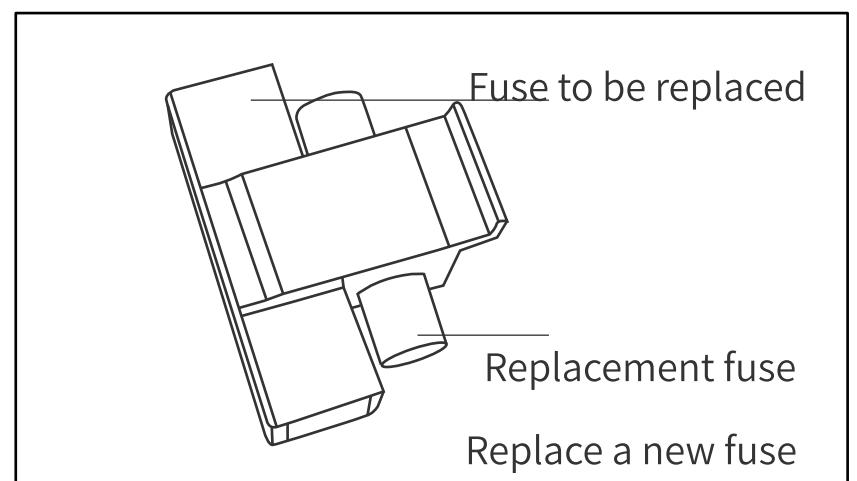
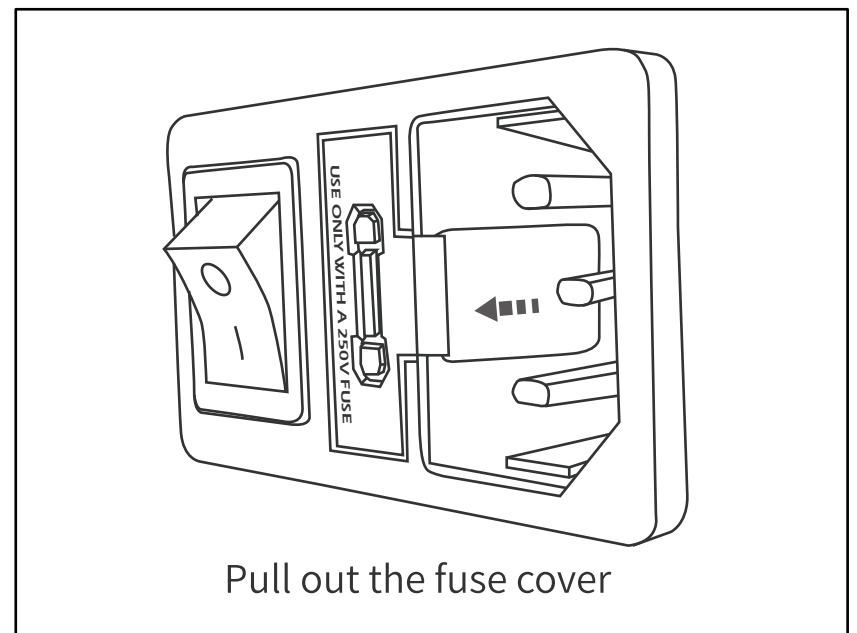

FAQ AND SOLUTIONS

1: The system is still working, but the air volume is weak, and the suction force is significantly reduced.

Cause: The air intake is blocked, or there is foreign matter in the tubing, and the filter element reaches saturation failure, resulting in a blocking alarm.

Check: turn off the power supply, check whether there is any foreign matter blocking the air intake, and then check whether the air outtake is blocked. If the suction of the air compressor is normal, the filter element needs to be replaced.

2: The machine is normally energised, the motor starts slowly, the speed is sometimes fast, sometimes slow.

Cause: Motor Drive Board Failure.

Tackle: Contact the manufacturer or dealer to replace the driver board.

3: Turn on the power switch and the indicator light is not on

Check the socket for poor contact, if the power socket is intact. Then check whether the fuse in the power box is blown, if it is damaged, replace the fuse.

Be sure to cut off the power before checking and repairing the equipment!

WARRANTY

As for the warranty (free repair) of goods within the warranty period, it shall be implemented from the date of purchase.

1. The product can be returned to the factory for repair within the warranty period. Please show us this User's manual(Warranty) and purchase invoice.

2. From the date of purchase, the main unit is guaranteed for ____ years.
(Note: the filter element belongs to consumables and is not under warranty scope of repair)

3. Under one of the following circumstances, even within the warranty period, it can not be treated as a warranty, but it can be bank charge processing:

I Damage caused by failure to use, maintain or store in accordance with the operating instructions;

II Damage caused by incorrect operation, abnormal power supply, and falling;

III Use of non-original cartridges or accessories and use without placing the cartridge;

IV Damage caused by dismantling the machine without the consent of the manufacturer;

V Failure to prove that the machine is within the valid warranty period;

VI The information on the warranty certificate is inconsistent with or altered from the physical identification of the goods;

VII Damage due to nuclear and chemical corrosion;

VIII Damage due to natural measures (lightning, earthquake, flood, fire, and other natural disasters).

4. Before using this equipment, please strictly comply with the operating instructions, regular inspection and replacement of the cartridge, is strictly prohibited in high temperature (60 ° C and above), high humidity, flammable, explosive, corrosive and strong electrical environment. (60 ° C and above), high humidity, flammable and explosive, easy to corrode and strong electric environment, if this causes a safety accident or machine failure, the company has nothing to do. If this causes safety accidents or machine failure, the company has nothing to do with it.

V1.0 2024.03

