

Pulse dust collector

# RW601L

## Instruction Manual

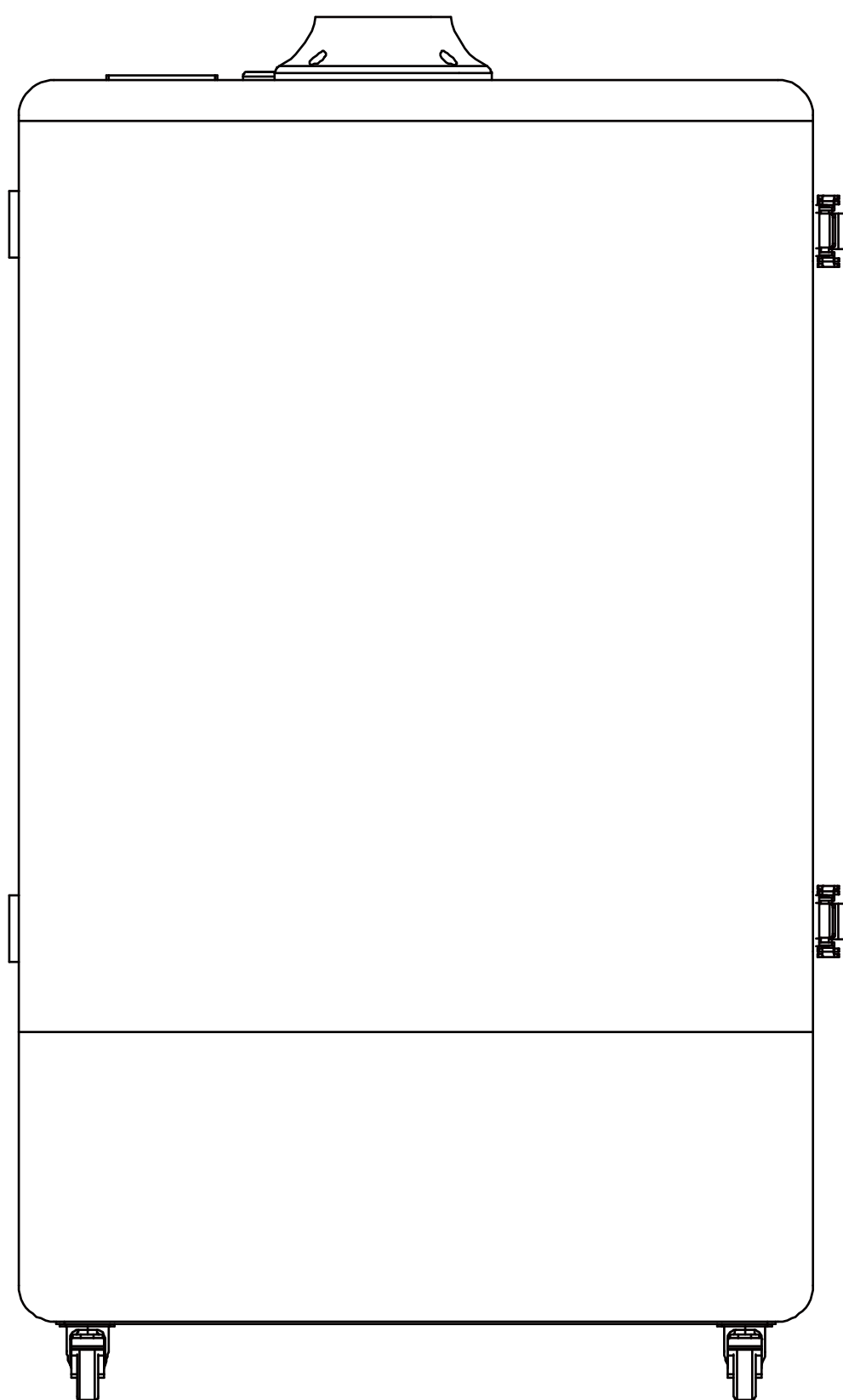

Thank you for purchasing our pulse dust collector.  
Please read this manual carefully  
before use and keep it properly for future reference.

# CONTENT

OVERVIEW	1
SPECIFICATIONS	1
PRODUCT FEATURES	2
PACKING LIST	2
STRUCTURE	3
INSTALLTION INSTRUCTIONS	4
ELECTRICAL CONFIGURATION DIAGRAM	4
FILTERS	5
CONTROL KNOB	6
FUSE REPLACEMENT	6
TIMING RELAY	7
AIR SOURCE PROCESSOR	8
WARRANTY	9

## OVERVIEW

This product is a dust filtration and recovery equipment for grinding, engraving, marking and other scenes in the hardware processing, photovoltaic, laser equipment industry, in line with the concept of "simple and efficient, save money and worry", the filtration system is equipped with a pulse-type automatic ash removal function, the filter drum does not need to be cleaned manually, which greatly improves the service life of the filter drum and filtration efficiency.

This product is paired with a high-precision smoke and dust filtration system, which can effectively intercept 0.3μm smoke and dust, with a filtration efficiency of up to 99.7%. Smoke and dust are discharged after filtration, which can make the air continue to be fresh and clean, improve the cleanliness of the room, reduce the harm of PM2.5, and create a good working environment.

## SPECIFICATIONS

Series	RW601L
Voltage	AC110/220V 50Hz
Power	600W
Air volume	1000m <sup>3</sup> /h
Filtration	0.3μm 99.7%
Size	L480xW445xH840mm
Weight	52kg
Size of flange	φ75/110mm
Dust box capacity	5.9L

## PRODUCT FEATURES

### CENTRIFUGAL FAN

The fan has a brushless direct current motor with a maximum service life of 40 thousand hours.  
We assure the highest reliability, and our fan will require no maintenance.  
The fan produces low operating noise, high.  
rotation speed, high air volume, high air pressure, and high efficiency

### ELECTROMAGNETIC PULSE BLOWBACK SYSTEM

Equipped with manually programmable electromagnetic pulse automatic blowback system. It can regularly use high pressure gas to blow the dust adhered on the filter drum into the dust collection box. The high-pressure gas can be used to blow down the dust on the filter drum to the dust collection box, avoiding the clogging of the filter drum and avoiding the clogging of the filter drum and the decline of filtration efficiency due to untimely dust removal.

## PACKING LIST

Description	QTY	Size	Model	Note
Main machine	1 set	L480xW445xH840mm	RW601L	
Power cord	1 pcs	1.8 meters		
Smoking pipe	1 pcs	Bamboo tube		
Smoke extraction hood	1 pcs	Silicone rectangular cover		
Filter barrel	1 pcs	Φ320x280mm		
Medium / High efficiency filter	1 pcs	L445xW375xH50mm		either-or
Dust box	1 pcs	5.9L		

Note: Filter cartridges are placed inside the machine

STRUCTURE

1	Air Inlet
2	Operation indicator
3	Speed knob
4	Independent dust removal switch
5	Timing relay
6	Air source processor assembly
7	Air outlet
8	Three-in-one switch

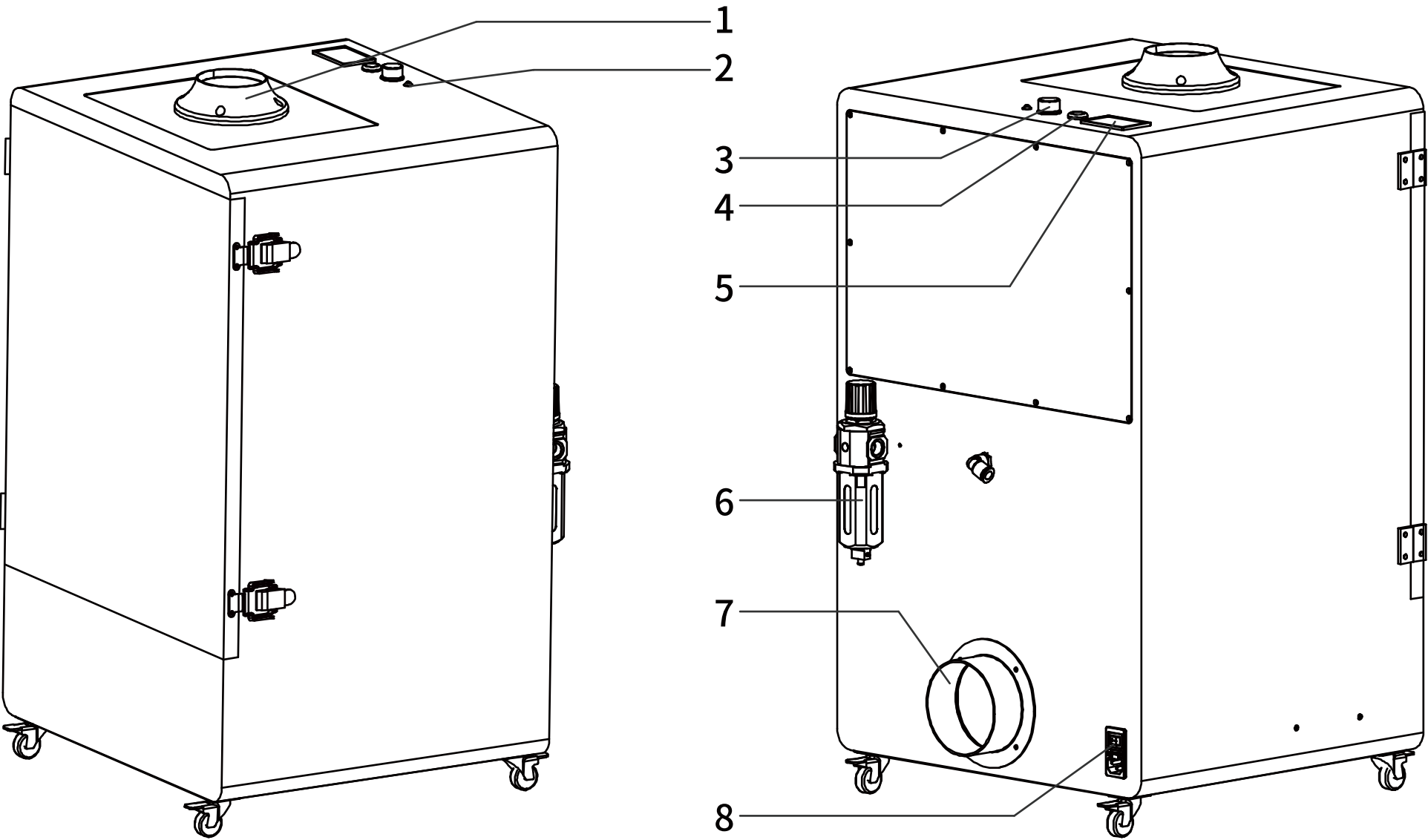

# INSTALLATION NOTES

- 1. Plug one end of the power cord into the 3-in-1 switch on the unit. Plug the other end into an electrical socket and turn on the switch.
- 2. Turn the airflow control potentiometer to start working.

Note: When using it, you should try to make the smoking mouth directly to the point of smoke generation. In order to improve the efficiency of smoking and dust collection. The equipment must be switched on with a well grounded plug and socket.

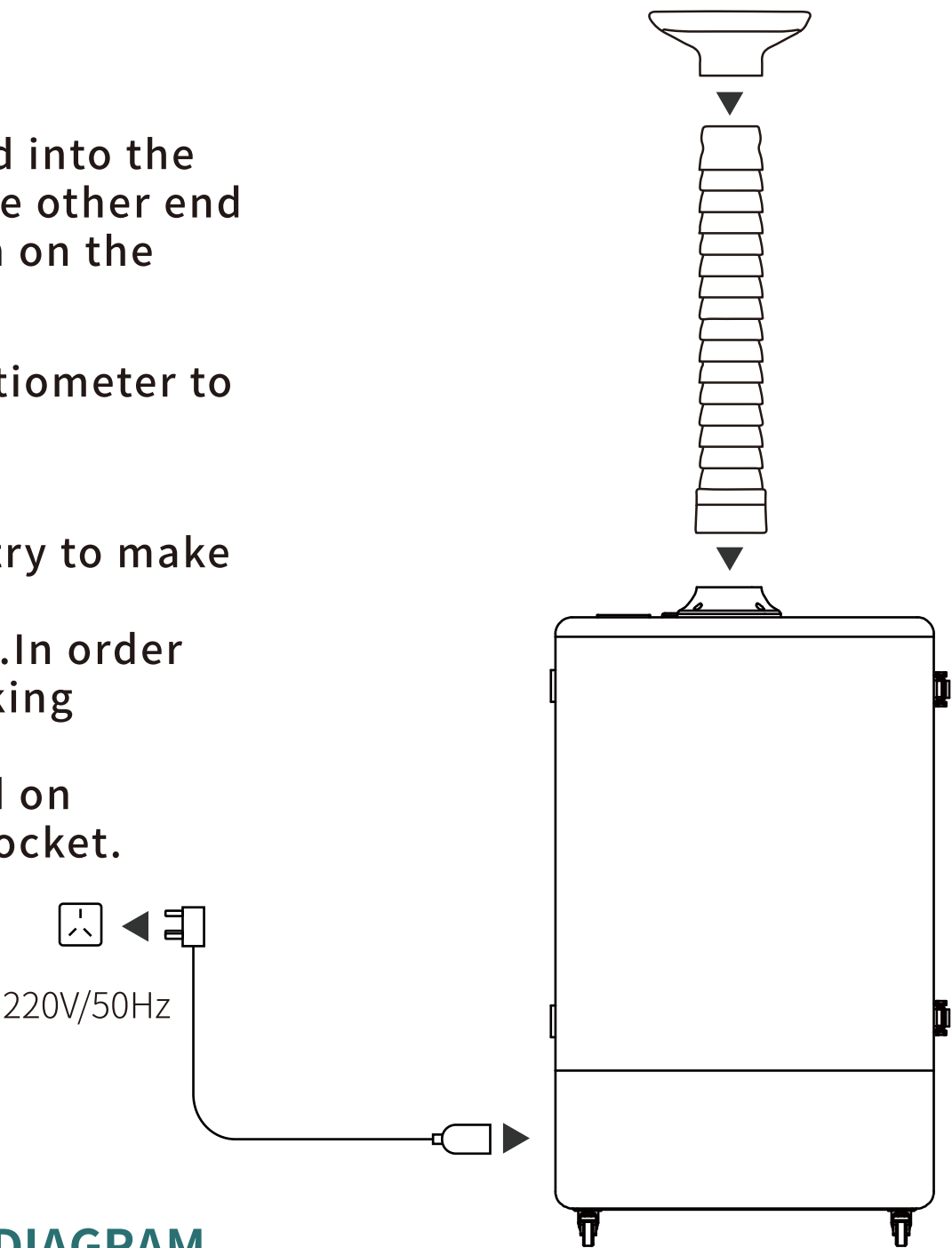

# ELECTRICAL CONFIGURATION DIAGRAM

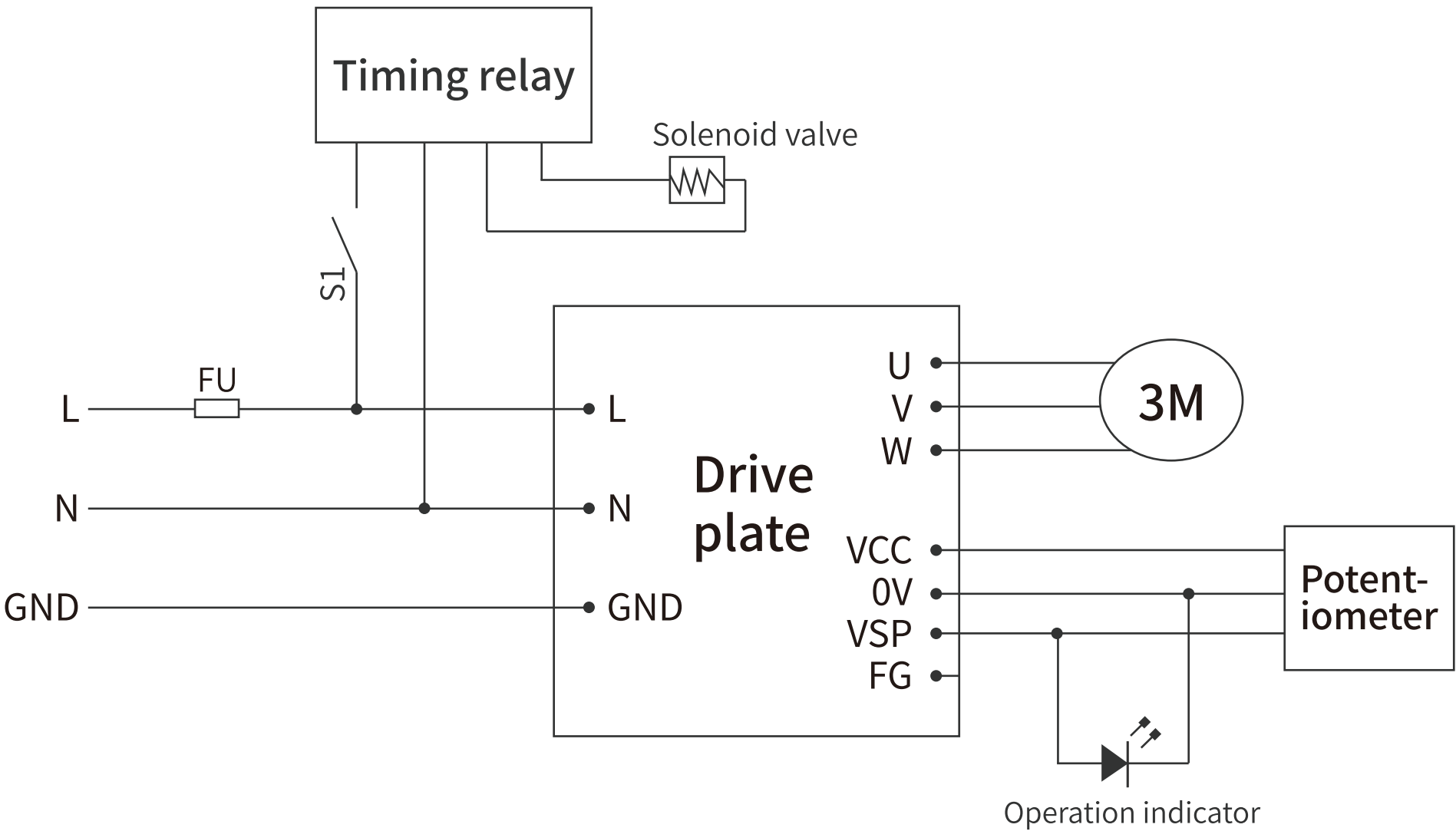

FILTERS

	Description	Replacement period	Replacing method
1	Filter barrel	6-8 months	Turn counterclockwise
2	Dust box	reuse	Pull out
3	Medium efficiency filter	2-4 months	Pull out

Note:The above replacement cycle is for reference only, the actual replacement time depends on the working conditions.

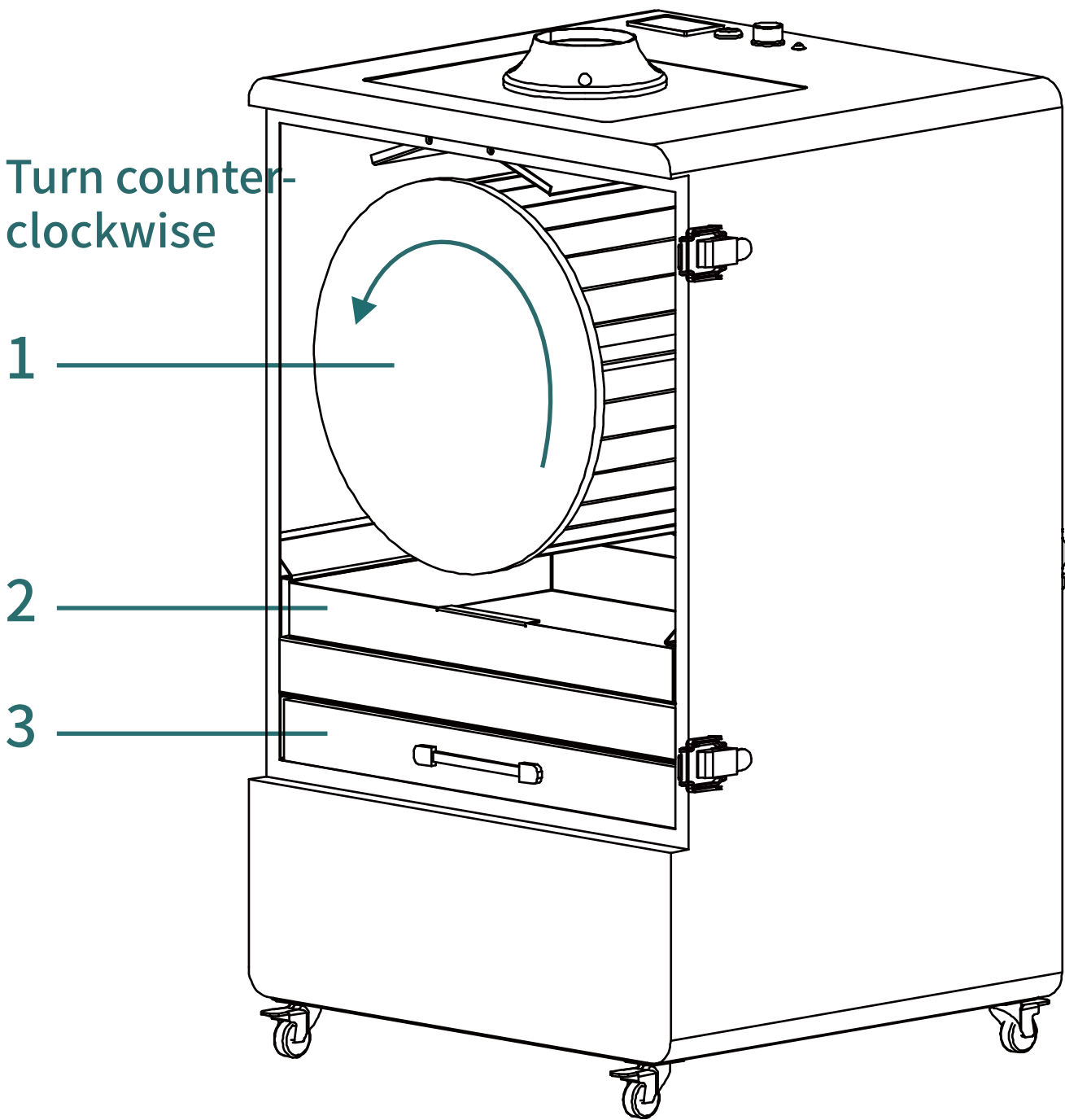

## CONTROL ROTATION BUTTON

Plug the power cord into the 3-in-1 power switch and turn on the main switch. switch and turn on the main switch, the device will enter the standby The device will enter standby mode.

Twist the potentiometer clockwise, when it starts to energise, the indicator light is on, the motor then starts to work. The knob travelling is about 270° angle, 0° is the power-off shutdown, the 270° is the maximum speed of the motor. The user can adjust the equipment in real time according to the current The user can adjust the motor speed in real time according to the current working conditions.

**Note:** Due to the need to meet the purification and filtration needs of different industries, the maximum air volume of this equipment may be oversaturated for the current working conditions. When users use it, they only need to adjust the motor speed to the suction force that can meet the purification and filtration. This operation can also avoid the equipment Excessive noise is produced.

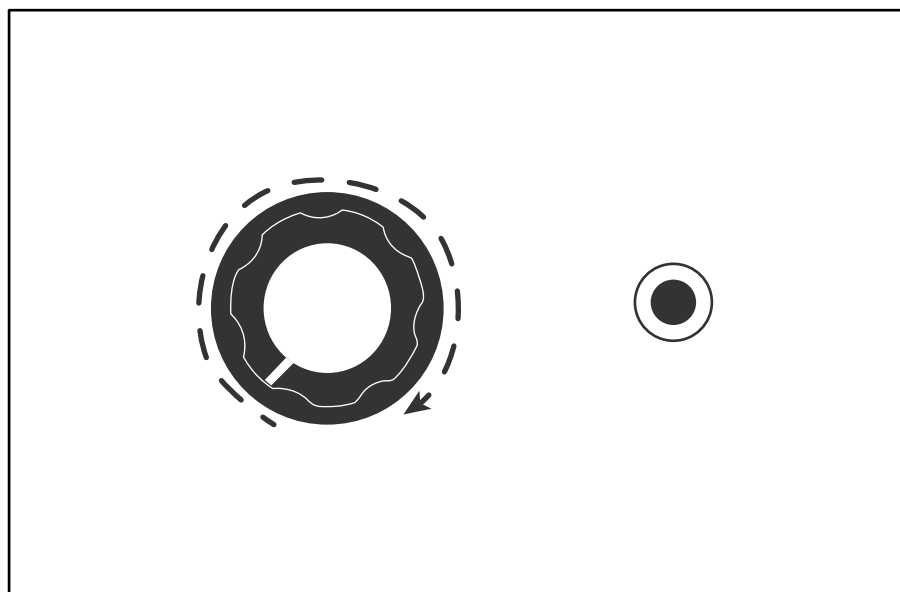

## FUSE REPLACEMENT

If the device is short-circuited and the fuse is damaged, Follow the steps below to replace the fuse.

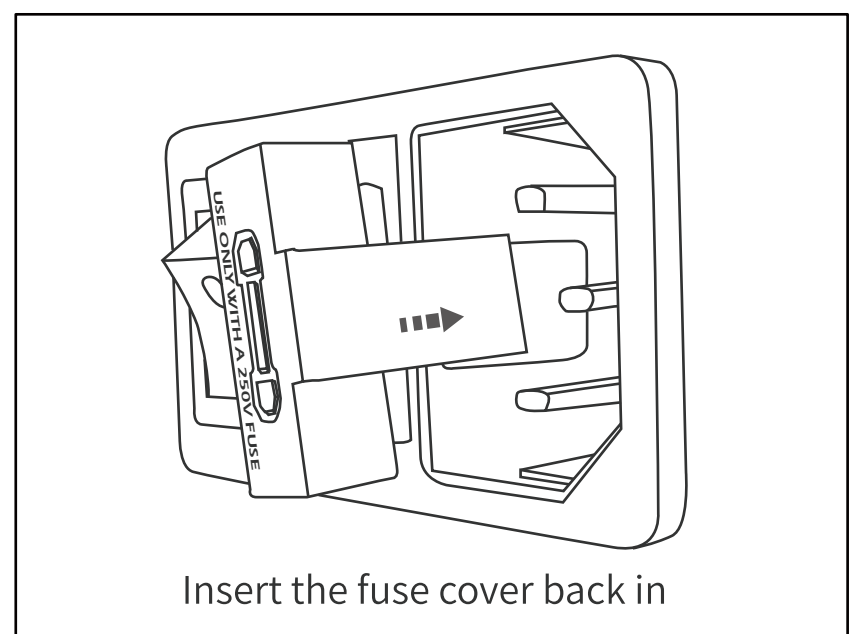
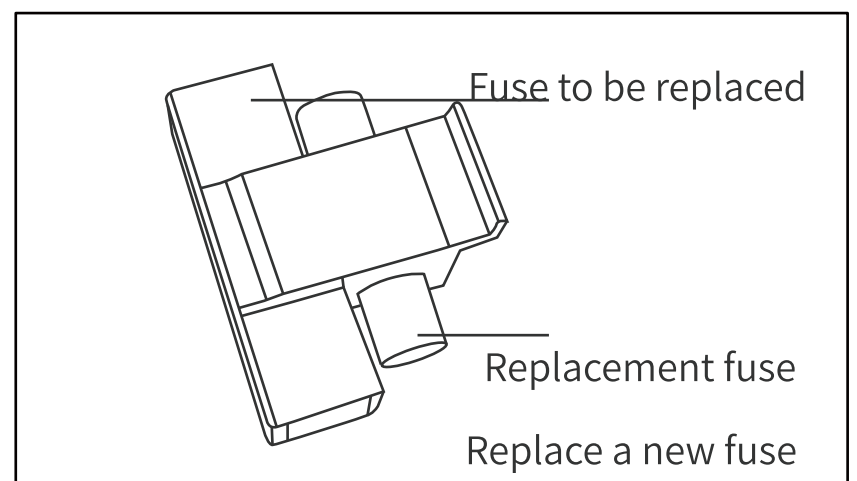
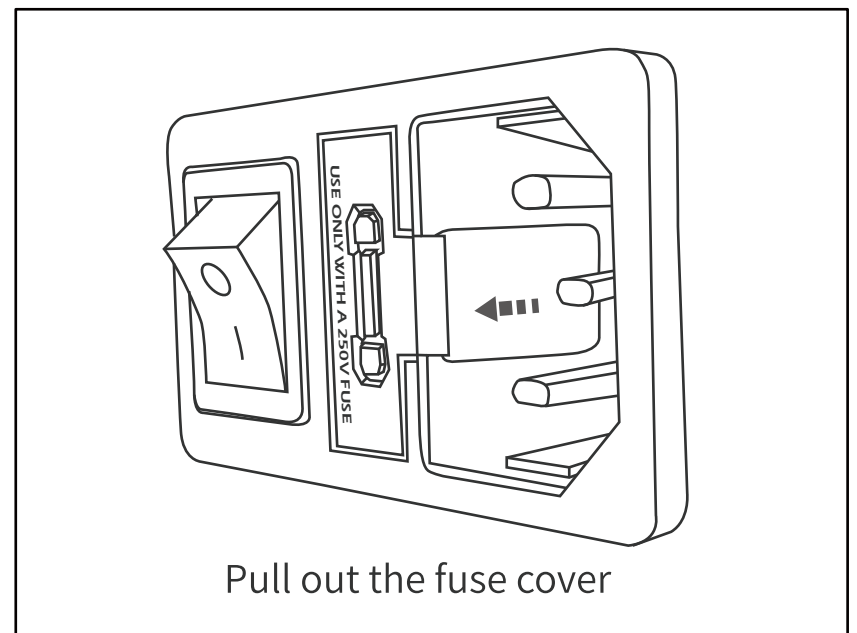



## TIMING RELAY

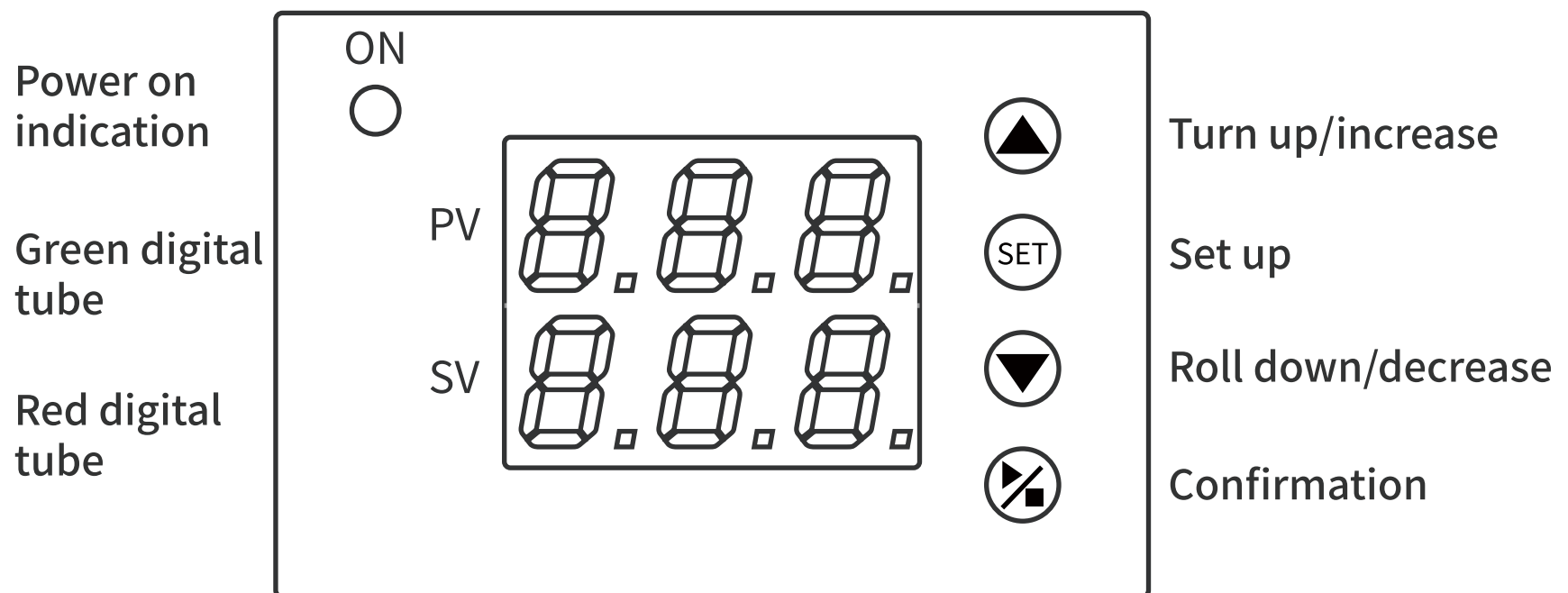

Warm prompt: before the machine leaves the factory, the automatic cleaning interval has been adjusted for you to "blow back 1 second every 30 minutes". If it does not meet your needs, please follow the steps below to adjust yourself to the optimal working time.

## OPERATION DEMONSTRATION

Example required: 2 seconds of automatic backblow cleaning every 18 minutes. (This time is for demonstration purposes only, value to be varied as required.)

Operation introduction:

- ① Press the dust removal switch and long press the SET button to enter the code interface;
- ② P0 is the unit code for the blowback time, P1 is the unit code for the interval time, and the code can be switched by pressing the SET key. (Other codes remain unchanged by default);
- ③ Press ▲ or ▼ to set the unit of blowback time to 0 for P0 and the unit of interval time to 1 for P1.  
(Note: 0 stands for "second", 1 stands for "minute", 2 stands for "hour");
- ④ When the time unit code is set, press the confirmation button to save;
- ⑤ Press the SET key twice, the green digital tube (PV) blinks, press ▲ or ▼ to adjust the value to 2;
- ⑥ Press the SET key once, the red digital tube (SV) flashes, press ▲ or ▼ to adjust the value to 18;
- ⑦ Press the confirmation button to save, and the interval backblow time is set.

# AIR SOURCE PROCESSOR

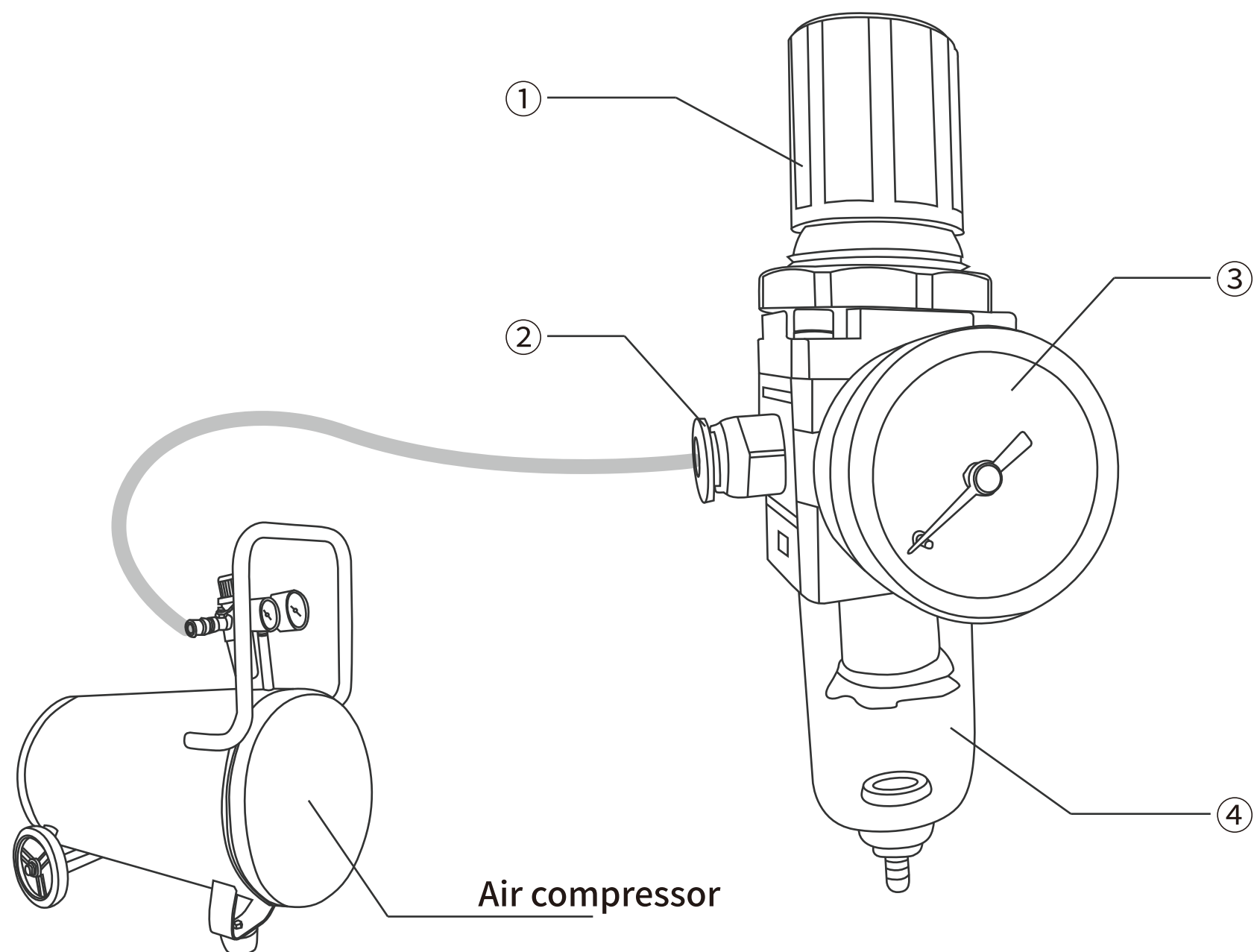

Serial number	Illustrate
①	Regulating rotary button
②	8x5 air inlet
③	Pressure gauge
④	Water storage cup

Note: The working pressure of this machine is 0.4-0.6MPa, please use dry and clean compressed air and drain it regularly.

## WARRANTY

As for the warranty (free repair) of goods within the warranty period, it shall be implemented from the date of purchase.

1. The product can be returned to the factory for repair within the warranty period. Please show us this User's manual(Warranty) and purchase invoice.

2. From the date of purchase, the main unit is guaranteed for \_\_\_\_ years.  
(Note: the filter element belongs to consumables and is not under warranty scope of repair)

3. Under one of the following circumstances, even within the warranty period, it can not be treated as a warranty, but it can be bank charge processing:

I Damage caused by failure to use, maintain or store in accordance with the operating instructions;

II Damage caused by incorrect operation, abnormal power supply, and falling;

III Use of non-original cartridges or accessories and use without placing the cartridge;

IV Damage caused by dismantling the machine without the consent of the manufacturer;

V Failure to prove that the machine is within the valid warranty period;

VI The information on the warranty certificate is inconsistent with or altered from the physical identification of the goods;

VII Damage due to nuclear and chemical corrosion;

VIII Damage due to natural measures (lightning, earthquake, flood, fire, and other natural disasters).

4. Before using this equipment, please strictly comply with the operating instructions, regular inspection and replacement of the cartridge, is strictly prohibited in high temperature (60 ° C and above), high humidity, flammable, explosive, corrosive and strong electrical environment. (60 ° C and above), high humidity, flammable and explosive, easy to corrode and strong electric environment, if this causes a safety accident or machine failure, the company has nothing to do. If this causes safety accidents or machine failure, the company has nothing to do with it.

V1.0 2024.04

